

SC156 Lift and Slide Door System

The premium SC156 Door has been designed to meet the demands of projects that require the highest levels of thermal and weathering performance. Delivering a U-Value of $1.0\text{W/m}^2\text{K}$ (triple glazed), alongside superior water tightness of (1500 Pa), this highly sought-after system delivers enhanced capability without sacrificing style.

The elegant design features a slim interlock of 50mm and have been specifically created to provide greater design flexibility by enabling larger glazing areas to be achieved. The system's Lift and Slide technology uses high quality fittings that both ensure ease of operation and enables panel weights of up to 400kg to be incorporated into designs.

The SC156 is PAS 24-accredited and available in a range of configurations and options.

DESIGN FEATURES

- › Lift and Slide for smooth operation
- › PAS 24 Accredited
- › Exceptional AWW ratings
- › Low threshold of 23mm
- › Max 400kg panel weight

OPTIONS

- › Slimmer sightline of 50mm interlock
- › Accepts 24mm – 50mm double or triple glazing
- › Multiple sliding configurations
- › Mono or Dual rail options
- › Range of hardware and security features
- › Available in a range of single and dual colours, textured and anodised finishes



SPECIFICATIONS

	SC156	SC156 SLIM
PERFORMANCE AND ACCREDITATIONS		
U-value (Double Glazing) ($U_g = 1.0 \text{ W/m}^2\text{K}$) (Mono Rail)	1.4 $\text{W/m}^2\text{K}$	1.4 $\text{W/m}^2\text{K}$
U-value (Triple Glazing) ($U_g = 0.6 \text{ W/m}^2\text{K}$) (Mono Rail)	1.0 $\text{W/m}^2\text{K}$	1.0 $\text{W/m}^2\text{K}$
U-value (Double Glazing) ($U_g = 1.0 \text{ W/m}^2\text{K}$) (Dual Rail)	1.5 $\text{W/m}^2\text{K}$	1.6 $\text{W/m}^2\text{K}$
U-value (Triple Glazing) ($U_g = 0.6 \text{ W/m}^2\text{K}$) (Dual Rail)	1.2 $\text{W/m}^2\text{K}$	1.3 $\text{W/m}^2\text{K}$
Air Permeability	Class 4 (600 Pa)	Class 4 (600 Pa)
Water Tightness	Class E1500 (1500Pa)	Class E1500 (1500Pa)
Wind Resistance	Class 4 (1600 Pa)	Class 4 (1600 Pa)
Acoustic Performance	$R_w(C_t; C_{tr}) = 44$ (-2;-6) dB	$R_w(C_t; C_{tr}) = 44$ (-2;-6) dB
Security	PAS 24	PAS 24
SYSTEM		
Depth	156mm	156mm
CONFIGURATIONS		
Opening	Lift & Slide	Lift & Slide
Mono Rail	✓	✓
Dual Rail	✓	✓
SIZE AND WEIGHT LIMITS		
Max Frame Height	3100mm	3100mm
Max Vent Height	3100mm	3100mm
Max Vent Width	2700mm	2700mm
Max Vent Weight*	300kg	300kg
GLAZING		
Glazing Options	Internal	Internal
Glazing Thickness	24mm-50mm	24mm-50mm
SYSTEM FEATURES		
Single Colour	✓	✓
Dual Colour	✓	✓
Textured Finish	✓	✓
Anodised Finish	✓	✓
Multi-Point Locking	✓	✓
Threshold	23mm	23mm
Sightlines	95mm	50mm

* 300kg on standard roller sets, 400kg with additional roller set

CONFIGURATIONS

MONO RAIL



DUAL RAIL

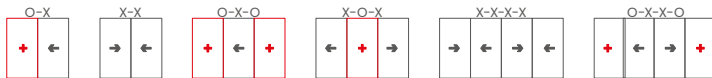

KEY



CAD CROSS SECTIONS AND THERMAL PROFILE

Additional details are available on request.

SC156 Head

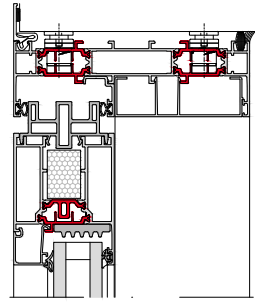

SC156 Interlock

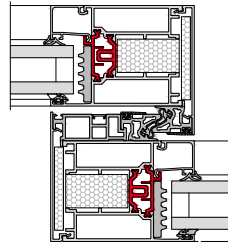

SC156 Interlock Slim

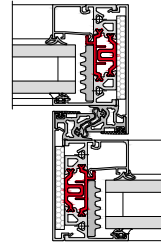

SC156 Cill

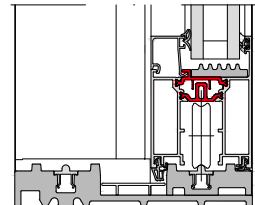

SC156 Jamb

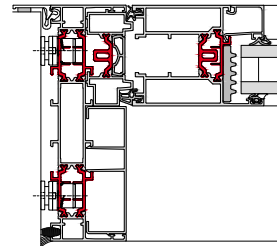

SC156 Thermal Profile

